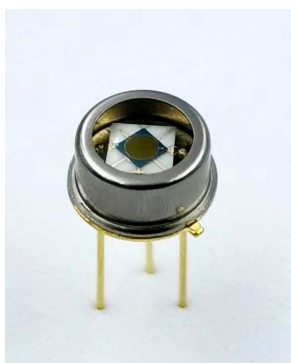

900-1700nm 2mm InGaAs PIN Photodiode**Model:NIP2000****NIP2000-F****Applications**

- ◆ Optical power meter
- ◆ Optical sensor
- ◆ Science analysis
- ◆ Industrial automatic control
- ◆ Space light detect

Features

- ◆ Top illumination Planar PIN PD
- ◆ Low dark current, High reliability
- ◆ Active area diameter 2mm
- ◆ Hermetical TO5 Can

Absolute Maximum Ratings (Tc=25°C)

Parameter	Symbol	Unit	value
Storage temperature	Tst	°C	-40 ~ + 100
Operating temperature	Top	°C	-40 ~ + 85
Soldering temperature(time)	Ts (10s)	°C	260
Reverse voltage	Vr	V	10

Optical & electrical characteristics (Tc=25°C)

Parameter	Symbol	Test Conditions	Unit	value (Typ.)
Response spectrum	λ		nm	900-1700
Active area diameter	Φ		mm	2
Responsivity	Re	Vr=0V, λ =1310nm	mA/mW	0.85
		Vr=0V, λ =1550nm	mA/mW	0.90
Dark current	Id	Vr=0V	nA	0.8
		Vr=3V	nA	2.5
response time	Tr	RL =50 Ω , Vr=3V	ns	100
Capacitance	Ct	f=1MHz, Vr=0V	pF	1600
		f=1MHz, Vr=3V	pF	400
Reverse operating voltage	Vr		V	0-3
Reverse breakdown voltage	VBR	Id=10uA	V	18
Saturated optical power	Ps	Vr =0V	mW	6
		Vr =3V	mW	15
Shunt resistance	Rsh	Vr =10mV	M Ω	10
Package	Hermetic TO5 Can			

Dimensions (mm)

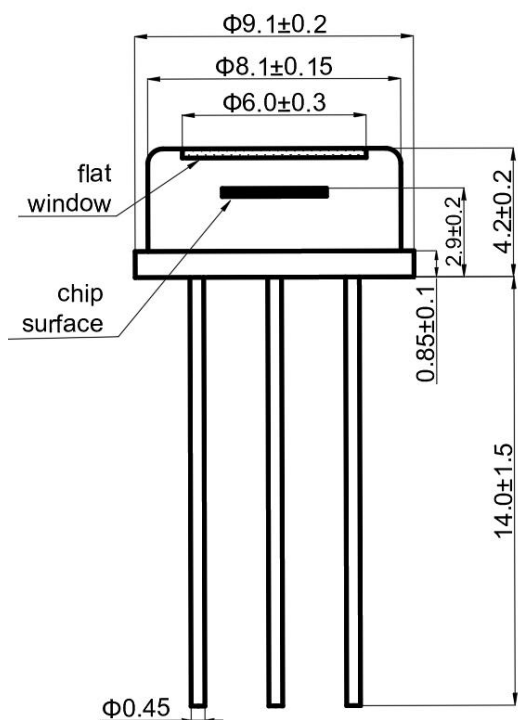

Pin Assignment (Bottom View)

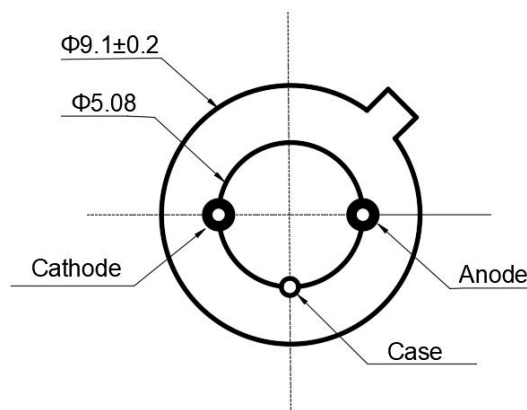

Typical responsivity curve(Tc=25°C)

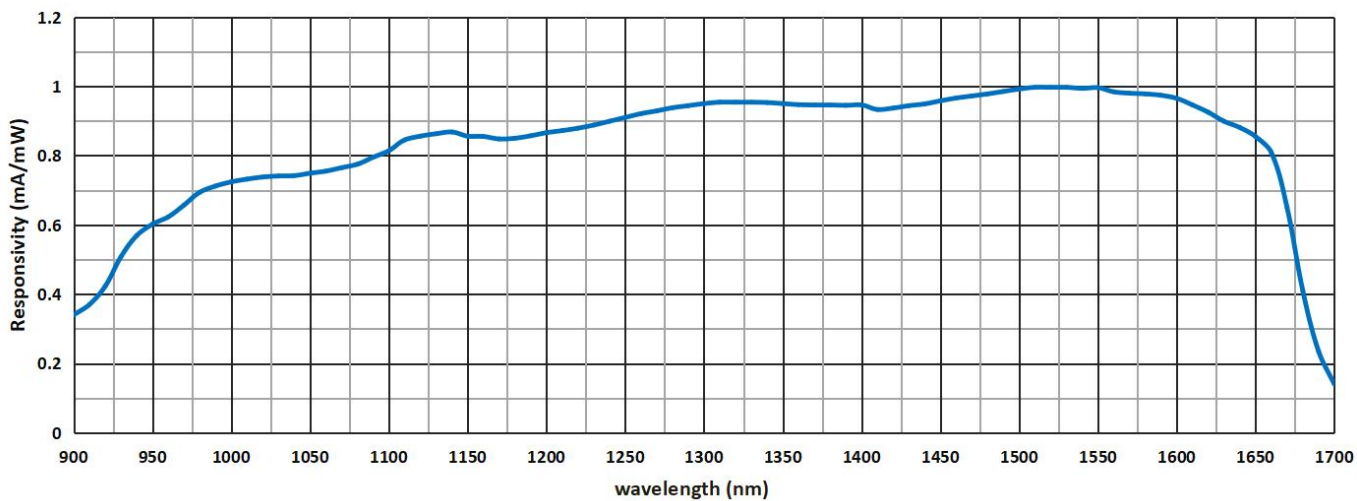

Order information

NIP2000-X: N=Ninglight IP=InGaAs PD 2000=2mm active area diameter
 X=F: TO-5 Can with ϕ 8.1mm flat window cap

The cautions

- 1: The above product specifications are subject to change without notice.
- 2: The suitable ESD protection is required in storage, transportation and using.